

## R-6038SB

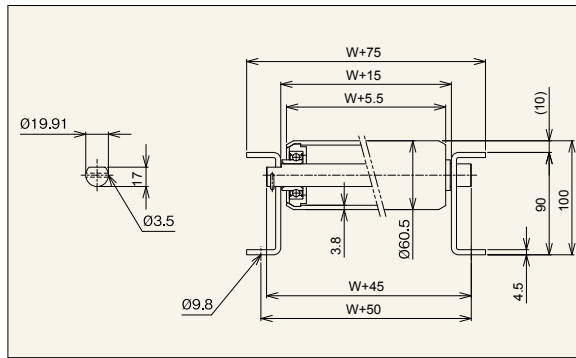

The connector plate is an optional extra.



[Intended Application] Conveying heavy loads  
[Product Characteristics]

- 1) We have changed the precision-machined bearing of the previous model R-6038 to a bearing that meets standards, improving the quality of the idler.
  - 2) Idler diameter is  $\phi 60.5$ , wall thickness is  $t \ 3.8$ , idler pitch is min. P75.
  - 3) Idler width (nominal) is 100W-1,000W in standard increments of 50mm. Free sizes are also possible.
  - 4) [ 90 standard frame
- Caution 1. Please indicate the connector plate (the connecting part between conveyors) separately when required.  
Caution 2. If the idler pitch (P) is not cleanly divisible, then a suitable pitch (P) will be chosen.

### Unit Width / Idler Strength / Standard Weight

| Idler Width (Nominal) W (mm)      | 100   | 200   | 300   | 400   | 500   | 600   | 700   | 800   | 900   | 1,000 |
|-----------------------------------|-------|-------|-------|-------|-------|-------|-------|-------|-------|-------|
| Unit Width W+75 (mm)              | 175   | 275   | 375   | 475   | 575   | 675   | 775   | 875   | 975   | 1,075 |
| Strength of One Idler (kg)        | 475   | 475   | 475   | 475   | 475   | 475   | 450   | 420   | 400   | 380   |
| Conveyor Standard                 | 75P   | 77.9  | 109.8 | 140.3 | 170.8 | 201.2 | 231.2 | 262.1 | 292.5 | 323.0 |
|                                   | 100P  | 65.8  | 90.2  | 113.2 | 136.2 | 159.2 | 181.9 | 205.2 | 228.2 | 251.2 |
| Idler / Shaft Standard Weight (g) | 1,215 | 1,961 | 2,707 | 3,454 | 4,199 | 4,943 | 5,690 | 6,436 | 7,182 | 7,927 |

Caution 1. Idler strength has been calculated using the standard specifications of our company's standard conveyors and shafts. Please take care if you are providing your own shafts or frame.  
Caution 2. The strength changes according to the conditions of use (whether there is impact or not). The values given in the chart are approximate values, and are not guaranteed.

### Idler Unit Specifications

| Conveyor Model | Idler Unit Model | Idler Dimensions   |                    |                  | Idler Width                      |                               |                   |                   | Idler Specifications |          |                    | Bearing Specifications |
|----------------|------------------|--------------------|--------------------|------------------|----------------------------------|-------------------------------|-------------------|-------------------|----------------------|----------|--------------------|------------------------|
|                |                  | Outer Diameter (φ) | Wall Thickness (t) | Shaft Indent (φ) | Standard Idler Width (Nominal) W | Standard Full Idler Length BB | Possible Width    |                   | Free Size            | Material | Surface Treatment  |                        |
|                |                  |                    |                    |                  |                                  |                               | Minimum Width (W) | Maximum Width (W) |                      |          |                    |                        |
| R-6038SB       | R-6038SB         | 60.5               | 3.8                | 20.0             | 100 - 1,000                      | W+13                          | 50                | 1,500             | Y                    | SGP50A   | None/Black surface | Meets standards        |

### Standard Shaft Specifications

| Shaft Diameter (φ) Nominal (Actual) | Shaft Length (mm) | Shape        | Finish                                | Material | Plating |
|-------------------------------------|-------------------|--------------|---------------------------------------|----------|---------|
| 20 (19.91)                          | W+45              | Circular rod | Circular/Horizontal crescent pin hole | SS400    | X       |

### Idler Conveyor Specifications

| Frame Specifications                      |          |                   | Manufactured Range of Standard Lengths |       |       |       | Standard Idler Pitch | Unit Height (Idler Upper Surface) H |     |
|---|----------|-------------------|--|-------|-------|-------|----------------------|-------------------------------------|-----|
| Height x Width x Wall Thickness I x K x t | Material | Surface Treatment | Unit Length L                          |       |       |       |                      |                                     |     |
|   |          |                   | 1,000                                  | 1,500 | 2,000 | 3,000 | R900 Inner Curve     | Pitch P                             |     |
| [90x30x4.5]                               | Steel    | Baked-on coating  | Y                                      | Y     | Y     | Y     | Y                    | 75 / 100<br>150 / 200               | 100 |

Caution: If you are supplying your own shafts, please ensure that the shaft diameter has a negative tolerance.

## R-7642N



The connector plate is an optional extra.

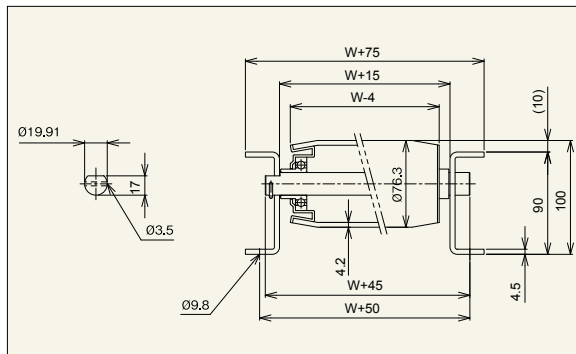

[Intended Application] Conveying heavy loads  
[Product Characteristics]

- 1) Idler diameter is  $\phi 76.3$ , wall thickness is  $t \ 4.2$ , idler pitch is min. P100.
  - 2) Idler width (nominal) is 100W-1,000W in standard increments of 50mm. Free sizes are also possible.
  - 3) High quality with precision-machined bearing
  - 4) [ 90 standard frame
- Caution 1. Please indicate the connector plate (the connecting part between conveyors) separately when required.  
Caution 2. If the idler pitch (P) is not cleanly divisible, then a suitable pitch (P) will be chosen.

### Unit Width / Idler Strength / Standard Weight

| Idler Width (Nominal) W (mm)      | 100   | 200   | 300   | 400   | 500   | 600   | 700   | 800   | 900   | 1,000  |
|-----------------------------------|-------|-------|-------|-------|-------|-------|-------|-------|-------|--------|
| Unit Width W+75 (mm)              | 175   | 275   | 375   | 475   | 575   | 675   | 775   | 875   | 975   | 1,075  |
| Strength of One Idler (kg)        | 550   | 550   | 550   | 550   | 550   | 550   | 520   | 488   | 456   | 425    |
| Conveyor Standard                 | 100P  | 76.4  | 106.6 | 136.8 | 167.1 | 197.3 | 223.3 | 253.5 | 283.7 | 313.9  |
|                                   | 150P  | 61.5  | 81.8  | 102.1 | 122.5 | 142.8 | 159.0 | 179.4 | 199.6 | 220.3  |
| Idler / Shaft Standard Weight (g) | 1,495 | 2,482 | 3,469 | 4,456 | 5,443 | 6,430 | 7,417 | 8,404 | 9,391 | 10,378 |

Caution 1. Idler strength has been calculated using the standard specifications of our company's standard conveyors and shafts. Please take care if you are providing your own shafts or frame.  
Caution 2. The strength changes according to the conditions of use (whether there is impact or not). The values given in the chart are approximate values, and are not guaranteed.

### Idler Unit Specifications

| Conveyor Model | Idler Unit Model | Idler Dimensions   |                    |                  | Idler Width                      |                               |                   |                   | Idler Specifications |          |                    | Bearing Specifications |
|----------------|------------------|--------------------|--------------------|------------------|----------------------------------|-------------------------------|-------------------|-------------------|----------------------|----------|--------------------|------------------------|
|                |                  | Outer Diameter (φ) | Wall Thickness (t) | Shaft Indent (φ) | Standard Idler Width (Nominal) W | Standard Full Idler Length BB | Possible Width    |                   | Free Size            | Material | Surface Treatment  |                        |
|                |                  |                    |                    |                  |                                  |                               | Minimum Width (W) | Maximum Width (W) |                      |          |                    |                        |
| R-7642N        | R-7642N          | 76.3               | 4.2                | 20.2             | 100 - 1,000                      | W+13                          | 100               | 1,500             | Y                    | SGP65A   | None/Black surface | Precision-machined     |

### Standard Shaft Specifications

| Shaft Diameter (φ) Nominal (Actual) | Shaft Length (mm) | Shape        | Finish                                | Material | Plating |
|-------------------------------------|-------------------|--------------|---------------------------------------|----------|---------|
| 20 (19.9)                           | W+45              | Circular rod | Circular/Horizontal crescent pin hole | SS400    | X       |

### Idler Conveyor Specifications

| Frame Specifications                      |          |                   | Manufactured Range of Standard Lengths |       |       |       | Standard Idler Pitch | Unit Height (Idler Upper Surface) H |     |
|---|----------|-------------------|--|-------|-------|-------|----------------------|-------------------------------------|-----|
| Height x Width x Wall Thickness I x K x t | Material | Surface Treatment | Unit Length L                          |       |       |       |                      |                                     |     |
|   |          |                   | 1,000                                  | 1,500 | 2,000 | 3,000 | R900 Inner Curve     | Pitch P                             |     |
| [90x30x4.5]                               | Steel    | Baked-on coating  | Y                                      | Y     | Y     | Y     | Y                    | 100 / 150<br>200 / 300              | 100 |